

# ROUTE 1

## GROUND FLOOR (RUSSIAN FLOOR 1)

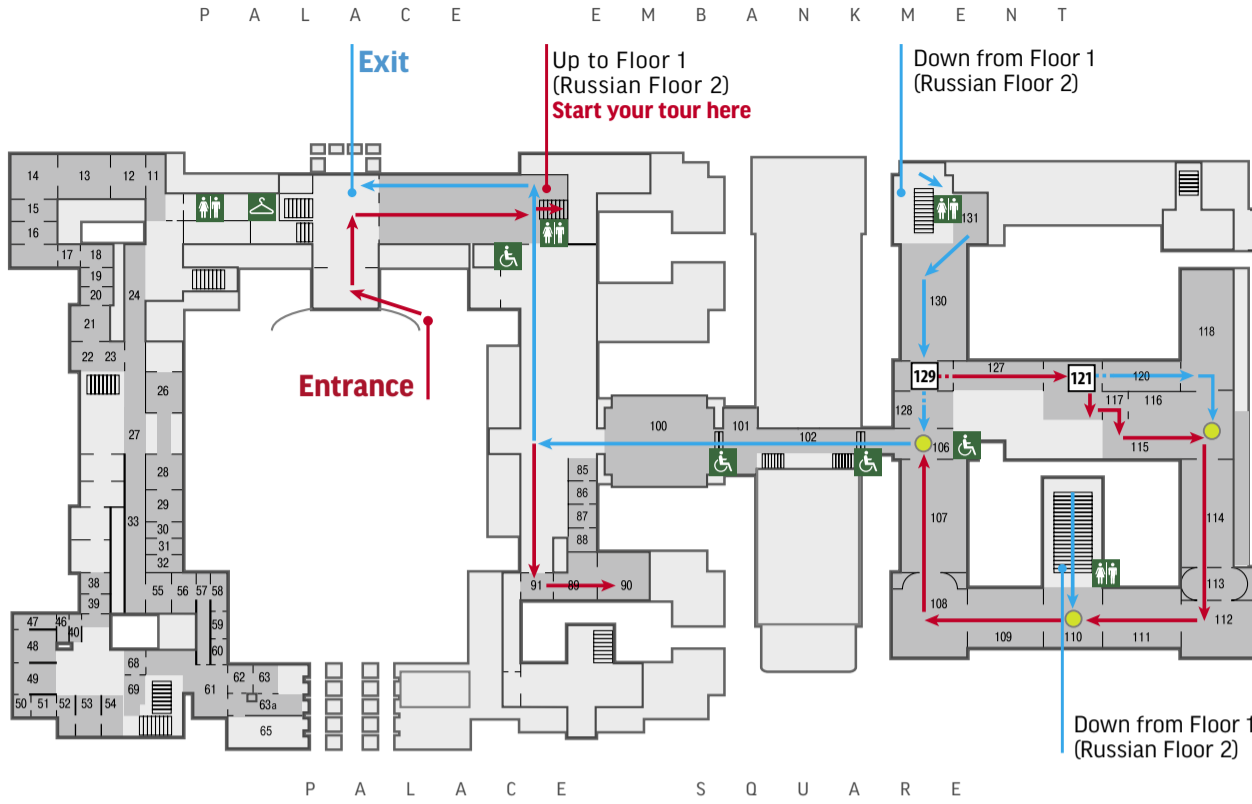

NUMBERS INDICATE THE ROOMS WHERE YOU CAN CHOOSE BETWEEN THE ROUTES.

COLOURED ARROWS INDICATE ROUTE DIRECTIONS.

- 193**
  - ▶ THE SUITE OF STATE ROOMS
  - ▶ THE MINISTERIAL CORRIDOR • RUSSIAN ICONS
- 200**
  - ▶ RUSSIAN ICONS • THE PAVILION HALL
  - ▶ THE PAVILION HALL
- 206**
  - ▶ THE PICTURE GALLERY
  - ▶ DOWN TO GROUND FLOOR (RUSSIAN FLOOR 1)
  - ▶ THE ART OF CLASSICAL ANTIQUITY • ANCIENT EGYPT • EXIT

- 207**
  - ▶ LEONARDO DA VINCI
  - ▶ TITIAN

## FLOOR 1 (RUSSIAN FLOOR 2)

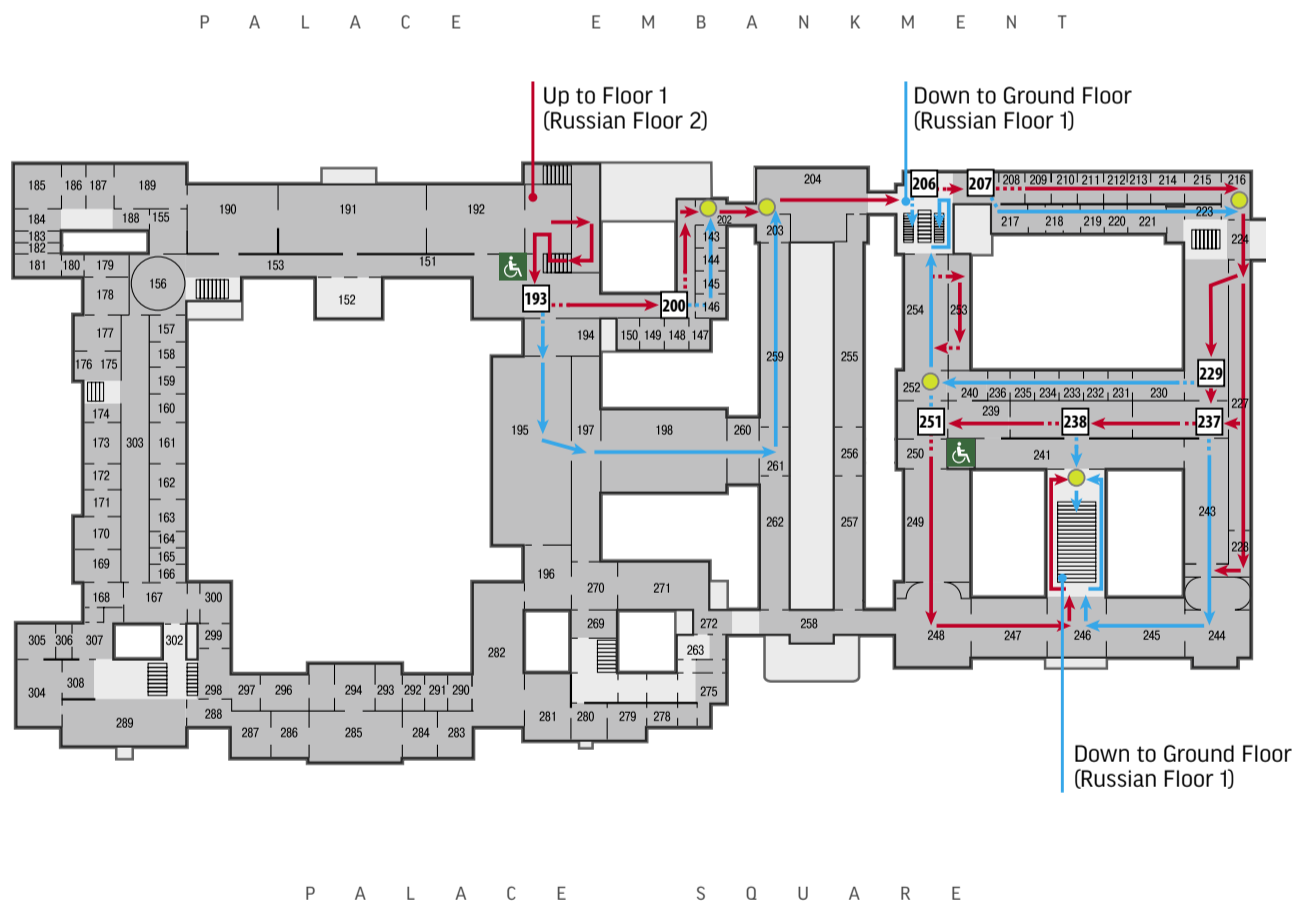

- 229**
  - ▶ THE KNIGHTS' HALL • ITALIAN ART • SPANISH ART
  - ▶ MICHELANGELO • ITALIAN ART • REMBRANDT

- 237**
  - ▶ THE KNIGHTS' HALL • SNYDERS • DOWN TO GROUND FLOOR (RUSSIAN FLOOR 1)
  - ▶ THE ART OF CLASSICAL ANTIQUITY • ANCIENT EGYPT • EXIT
  - ▶ ITALIAN ART • SPANISH ART • REMBRANDT • RUBENS

- 238**
  - ▶ SPANISH ART • REMBRANDT • RUBENS
  - ▶ DOWN TO GROUND FLOOR (RUSSIAN FLOOR 1)
  - ▶ THE ART OF CLASSICAL ANTIQUITY • ANCIENT EGYPT • EXIT

- 251**
  - ▶ DUTCH PAINTING • RUBENS • VAN DYCK
  - ▶ REMBRANDT • THE ART OF CLASSICAL ANTIQUITY • ANCIENT EGYPT • EXIT

- 129**
  - ▶ THE ART OF CLASSICAL ANTIQUITY • ANCIENT EGYPT • EXIT
  - ▶ ANCIENT EGYPT • EXIT

- 121**
  - ▶ THE HALL OF CARVED STONES • THE HALL OF VASES
  - ▶ THE ANTIQUITIES OF THE NORTHERN BLACK SEA AREA, FROM THE SEVENTH CENTURY BC TO THE THIRD CENTURY AD

**000** NUMBER OF THE ROOM WHERE YOU CAN CHOOSE BETWEEN THE ROUTES

▶ ROUTE DIRECTION

● ROUTE CONNECTION POINT

DISABLED ACCESS

TOILETS

CLOAKROOM